

ADURO TRAILLURY

WIRELESS IN CAR VISOR SPEAKER
For All Wireless Enabled Devices

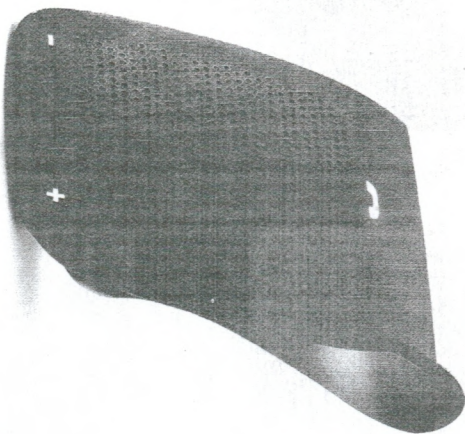

HANDS FREE CALLS WITH GREAT SOUND

Introducing the **TRAILLURY** Auto Visor Speaker, the portable in-car speakerphone with a powerful 2-watt speaker for incredible sound. Stay focused on the road ahead while enjoying hands-free calls and control over your phone. HD Microphone offers crystal clear calls with noise cancellation. When not taking the call, you can stream music, radio or GPS directions. Conveniently clips onto sun visor.

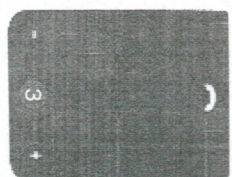

1. Multi-function Button
Play/Pause Audio,
Answer/Hang up/
Reject/Redial Calls
2. Large Speaker
3. Volume +/-
4. Microphone
5. ON/OFF Switch
6. Charging Port
7. LED Indicator
8. Clip



POWER ON/OFF

To power ON: Slide the Power switch located on the side of the unit to ON position.

To power OFF: Slide the Power switch located on the side of the unit to OFF position.

CHARGING VISOR SPEAKER

The Visor Speaker has an internal rechargeable battery. The battery must be fully charged prior to use. Charging time is approximately 3 hrs. Your Visor Speaker cannot be used while charging.

Red light ON - Charging
Red light OFF - Fully charged

- **Via AC Adapter**
Using the provided Micro USB cable, connect the Visor Speaker (Micro USB port) to the AC Adapter (USB port)
- **Via Computer**
Using the provided Micro USB cable, connect the Visor Speaker to the computer or laptop (USB port)
- **Via Automobile**
Connect to DC automobile rechargeable cigarette

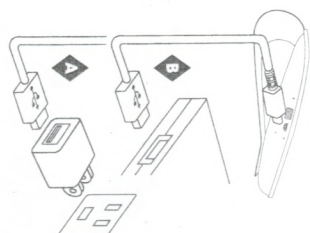

PAIRING THE VISOR SPEAKER TO DEVICE

Make sure the Bluetooth function is available on your cell phone. Specific pairing procedures will be different depending on different cell phone. For detailed information, please refer to your cell phone's User Guide.

PAIRING TO BLUETOOTH DEVICE (CONTINUED):

- If no device connection is made within 5 minutes of the Visor Speaker being switched on, the Visor Speaker will automatically be switched off to save power.
 - After a successful pairing devices will memorize each. Therefore, no pairing will be needed next time.
1. Slide the Power switch located on the side of the unit to turn the Visor Speaker ON.
 2. Keep the distance between the cell phone and the Visor Speaker within 3 feet (for pairing only).
 3. Activate the Bluetooth function of the cell phone, to search for the Bluetooth devices. After finishing the search, select "ADURO VSP80" in the device list displayed. If you phone asks for a passcode, enter 0000 (four zeros).
 4. Press "yes" or "enter" key to confirm the successful pairing.
 5. After the successful connection, the LED indicator will flash blue.
 6. Power off your Visor Speaker and turn off your Bluetooth device.
 7. If pairing was unsuccessful, repeat steps 1-3 above.

CONNECTING TO OTHER BLUETOOTH DEVICES

Note: Your Visor Speaker can only be connected to one Bluetooth device at a time.

1. In order to connect to the other Bluetooth device, you must first close the current Bluetooth connection.
2. Follow the above steps (under **PAIRING TO BLUETOOTH DEVICE**) to pair your Visor Speaker to another Bluetooth device.

VISOR SPEAKER CONTROLS

CALLS

Answer a call

Press the Multi-function Button once.

Reject a call

Press and hold the Multi-function Button for 3 seconds during an incoming call.

End a call

Press the Multi-function Button once.

Redial the last call

Double-press the Multi-function Button. The cell phone will redial the last number.

MUSIC

Play music

Press Multi-Function Button.

Pause/Resume music

Press Multi-Function Button.

Go to next song

Press "+" Button.

Go to previous song

Press "-" Button.

Volume +

Press and hold "+" Button.

Volume -

Press and hold "-" Button.

BATTERY DISPOSAL:

This product contains a lithium polymer battery. Lithium Polymer batteries are environmentally safe when fully discharged. Please refer to your local and state laws for battery disposal procedures.

IMPORTANT SAFEGUARDS

- Do not use this unit for anything other than its intended use.
- Keep the unit away from heat source, direct sunlight, humidity, water or any other liquid.
- Do not expose the device to extremely high or low temperatures, as it may damage the battery.
- Do not operate the unit if it has been wet or moist to prevent against electric shock and/or injury to yourself and damage to the unit.
- Do not use the unit if it has been dropped or damaged in any way.
- Reports to electrical equipment should only be performed by a qualified electrician. Improper repairs may place the user at serious risk.
- Keep the unit out of reach of children.
- This unit is not a toy.

SPECIFICATIONS

Bluetooth version: Bluetooth V4.1
 Operating Frequency: 2.402GHz-2.480GHz SIM
 Output power: Class 2, up to 33 feet (10 meters).
 Support Specification: HSP, HFP, A2DP, AVRCP
 Support multi-device pairing: Memory 8 Bluetooth pairing record
 Standby time: up to 1,600 hours / 66 days
 Talk time: 15-16 hours
 Charging time: about 3 hours
 Rechargeable Cigarette (not included): DC 5.0V, 500MA
 Battery: Built-in 1000mAh Polymer battery.

